



- 7 BUILT TO ROHS COMPLIANCE AND LEAD FREE WHERE SHOWN
- 6 IF APPLICABLE, MARK PART NUMBER AND REVISION APPLY EPOXY 2 PARTS
- 5 REMOVE INSULATION AND SOLDER TO BOBBIN LEADS
- 4 WIND BOTH COILS EVENLY SPACED CONSTRUCTION:

WEIGHT: ~ 26 GRAMS

HI-POT TEST FOR INTERWINDING ISOLATION = 1250VDC

OPERATING TEMP. RANGE = -40°C TO +125°C

|Z| = 13KΩ TYP. @ SRF

INTERWINDING CAPACITANCE = 17pF TYP @ SRF

LEAKAGE INDUCTANCE = 27μH TYP

SRF = 758KHz TYP

MAX. TEMP RISE AT RATED CURRENT = 20°C

RATED CURRENT = 6.6 AMPS AC MAX

DCR = 23 MILLI-OHMS MAX. PER WINDING

L = 1.8 mH MIN. ±25% @ 10KHz, 250mVrms

3 SPECIFICATIONS @ 25°C:

WIRE: UL RECOGNIZED 155°C OR 200°C RATED MAGNET WIRE

CWS BYTEMARK OR OTHER APPROVED PART

2 CORE: COATED FERRITE TOROID, HIGH PERM MNZN

1 RATING CLASS B (130°C) REQUIRED

MATERIAL: UL RECOGNIZED 94V-0 FLAMMABILITY FOR BOBBIN

NOTES: UNLESS OTHERWISE SPECIFIED, READ FROM BOTTOM UP.

CAGE CODE: 5DME2

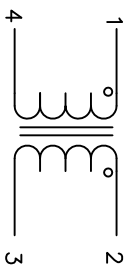

SCHEMATIC

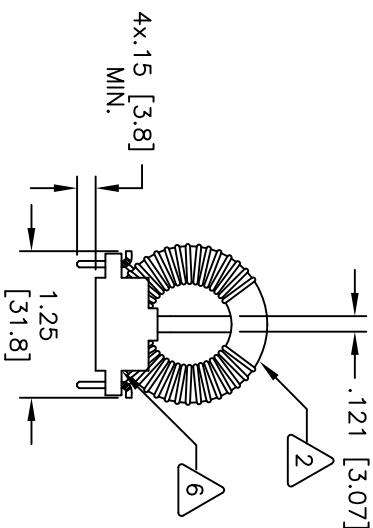

FRONT VIEW

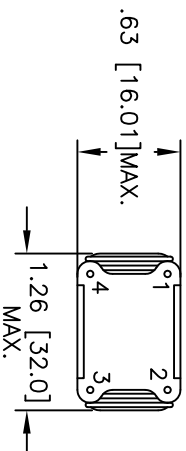

BOTTOM VIEW

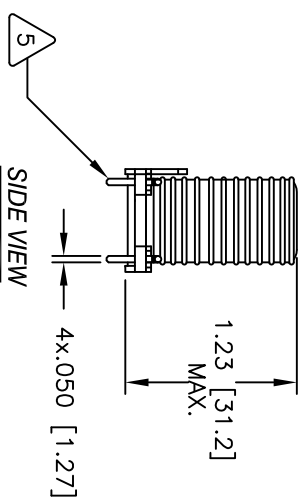

SIDE VIEW

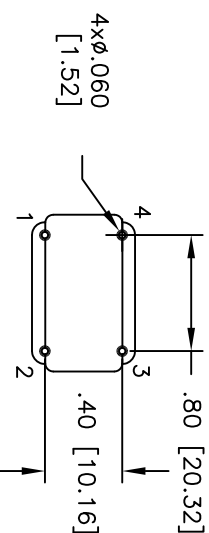

MOUNTING HOLES PATTERN

REVISION HISTORY					
REV	ECN	DESCRIPTION	BY	DATE	CHK
A		PRODUCTION RELEASE	TN	2/20/18	JL

CODE	IDENT	MFG. P/N	DESCRIPTION	ITEM NO.
PARTS LIST				
AUTOCAD		X		
SOLIDWORKS				
SIGN		DATE		
DRAWN		TN	2/20/18	
CHECKED		JL	2/20/18	
ENGR.		JM	2/20/18	
APPR.		JL	2/20/18	
SIZE		1/8" = 1" = 1	PM-12-182U-6.6A	REV A
SCALE		1 = 1		

COILWS.COM, INC
www.coilws.com
CWS Coil Winding Specialist.
353 W GROVE AVENUE
ORANGE, CA. 92865

TITLE:
Common Mode Line Chokes
1.8mH MIN., 6.6 Amp

UNLESS OTHERWISE SPECIFIED
DIMENSIONING AND TOLERANCE PER ANSI Y14.5M AND [MILLIMETERS].
TOLERANCE INCHES: .XXX=±.005 .XX=±.015 .X=±.030
TOLERANCE METRICS: .XXX=±.127 .XX=±.254 .X=±.508
ANGLE PROJECTION
DO NOT SCALE DRAWING